

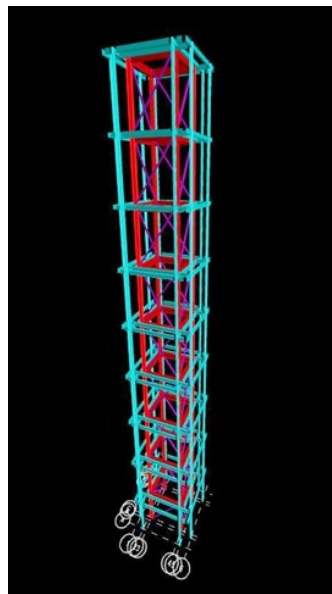

PROJECT PROFILE

Sonoma Raceway Pylar Sign Sonoma Valley Raceway



STRUCTURAL ENGINEER:

ADS Sports & Recreation, Morgantown, WV

CONTRACTOR:

Panasonic Corporation of North America, Newark, NJ

CONTRACTOR:

ES & A Sign & Awning Company, Eugene, OR

PROJECT SCOPE:

ADS Sports & Recreation is finishing design work on a 90' tall leaderboard tower for the Sonoma Raceway Complex in Sonoma, California. When completed, the tower will feature a four sided LED display highlighting real time updates of the races leaders. The impressive height of the tower will allow viewing from all areas of the complex but also required special seismic considerations to be taken into account. Specially designed steel braced frames were included in the design to account for the unique aspects required by this structure.

PROJECT COMPLETION:

2016

